

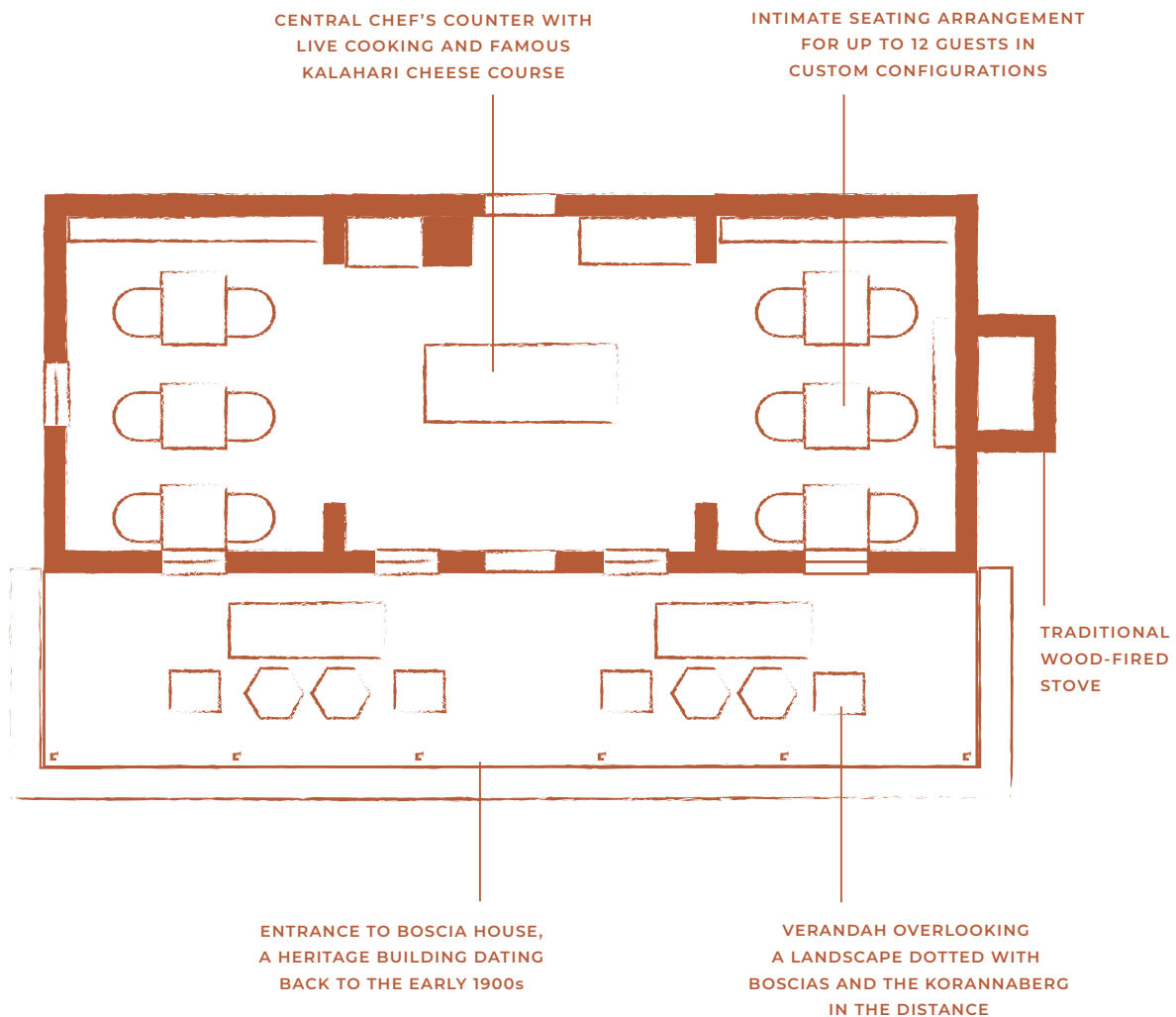

BOSCIA HOUSE POP-UP

Boscia House is an exclusive pop-up dining concept, created as an alternative to Klein JAN while restoration and planning for the new restaurant are underway. Set in a charming early 1900s heritage home, it offers a tasting menu rooted in hyper-local, seasonal ingredients in an intimate setting.



TSWALU KALAHARI RESERVE (Pty) Ltd.

T. +27 53 781 9331 | E. info@tswalu.com | W. tswalu.com

Farm Korannaberg 296, Van Zylsrus, 8467, South Africa | P.O. Box 1081, Kuruman, 8460, South Africa

FREQUENTLY ASKED QUESTIONS

What can guests expect from the experience?

Guests are welcomed by the front-of-house team and are invited to enjoy a cocktail on the verandah of Boscia House before dinner. The seven-course menu is paired with carefully selected wines. The dining experience is interactive, personal, and intimate, with each course introduced by the chef. At the end of the evening, guests are collected by their guide and driven safely back to camp.

What kind of food can guests expect?

A seven-course fine dining experience showcasing hyper-local, seasonal produce. The menu combines beautifully plated dishes with Kalahari-inspired elements, staying true to Tswalu's sense of place.

Why will guests enjoy dining at Boscia House?

Like a dune dinner or bush breakfast, Boscia House Pop-up is inclusive in the rate and offers an opportunity to experience another aspect of Tswalu. The unique setting complements the heritage-inspired menu celebrating local provenance. If guests would prefer to extend their game drive or return to camp for dinner, our team will tailor their experience accordingly.

How many guests can Boscia House accommodate?

The dining room comfortably accommodates 12 guests, though it can host up to 14 depending on the configuration. During summer, the verandah offers additional dining space.

What about guests who prefer private dining?

Every effort will be made to accommodate private dining requests where operations allow, though Boscia House's capacity makes this case dependent.

Can guests request a specific night?

Yes, based on availability.

Are children allowed?

Yes, families are welcome and there is a child-friendly menu for under 12s. Parents are encouraged to use their discretion, as the full dining experience takes approximately two hours.

Does Boscia House cater for dietary requirements?

Yes, most dietary requirements can be accommodated with prior notice, including vegetarian, vegan, gluten-free, and lactose-free options.

What time do guests need to arrive at Boscia House?

During the winter months, arrival is at 18h00; in summer, this will shift to 18:30, ensuring that game drives and wildlife sightings are not compromised.

How do guests book Boscia House?

Guests are guaranteed a dining experience at Boscia House; bookings are handled by our camp managers and are based on the length of stay and, ultimately, guest preferences.

Is there a minimum-stay requirement?

Boscia House is inclusive for guests staying two or more nights at Tswalu.

Is Boscia House open to non-resident guests?

Boscia House is exclusive to Tswalu guests.

TSWALU KALAHARI RESERVE (Pty) Ltd.

T. +27 53 781 9331 | **E.** info@tswalu.com | **W.** tswalu.com

Farm Korannaberg 296, Van Zylsrus, 8467, South Africa | P.O. Box 1081, Kuruman, 8460, South Africa

BOSCIA HOUSE POP-UP



TSWALU KALAHARI RESERVE (Pty) Ltd.

T. +27 53 781 9331 | E. info@tswalu.com | W. tswalu.com

Farm Korannaberg 296, Van Zylsrus, 8467, South Africa | P.O. Box 1081, Kuruman, 8460, South Africa